

Closer Pets

5000, 7000
9000

Ref. 472, 473, 474

The new home of

Cat Mate

Dog Mate

Fish Mate

Pond Pump · Instructions

IMPORTANT - READ BEFORE USE

IMPORTANT SAFETY INSTRUCTIONS

WARNING - To guard against injury or death, basic safety precautions should be observed, including the following:

READ AND FOLLOW ALL SAFETY INSTRUCTIONS

- Register your purchase on-line at www.closerpets.com (see guarantee overleaf).
- All electrical work must be carried out by a competent electrician.
- Check that the voltage label on the motor conforms with your supply voltage.
- The pump **MUST** be wired into a ground fault circuit interrupter (G.F.C.I.) maximum 30mA and a 3 AMP (maximum) fuse.
- Connection to the power supply should be made through a double pole switched enclosure with minimum 1/8" (3mm) contact separation in all poles.
- This appliance must be earthed. It is essential that all connections are securely made using the following code:
 - Brown – Live
 - Blue – Neutral
 - Green/Yellow – Earth
- Do not carry or pull the pump using the supply cord.
- Disconnect electrical supply from all appliances in the pond including pumps and filters before contact with the pond water or pump.
- Maximum operation depth is 5ft (1.5m).
- Do not use with water above 35°C.
- Closely supervise children when near to pond or pond equipment.
- Use pump only for ponds - do not use pump in connection with swimming pools, showers, etc.
- Use conduit approved by your electricity authority to protect supply cord where damage from gardening equipment, children and animals may occur.
- Discard pump if motor shows visual defects (e.g. cracks or swelling).
- The supply cord of this appliance cannot be replaced; if the cord is damaged the appliance should be discarded.
- Do not allow the pump to run dry.
- Do not operate the pump in freezing conditions. Remove, disassemble and dry pump if there is a risk of pump being frozen.
- This pump is provided with a thermal cut-out switch that temporarily switches off the pump in case of overheating. The pump may restart when it has cooled.

SAVE THESE INSTRUCTIONS

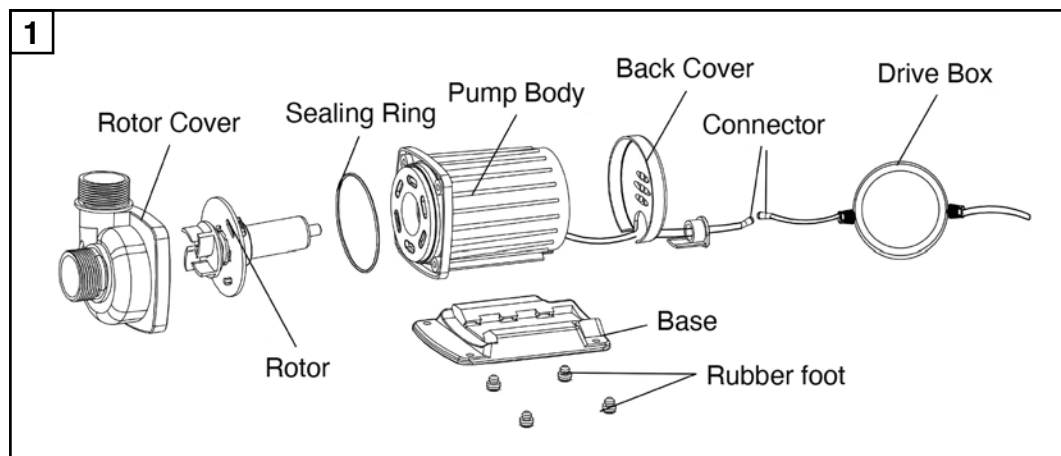

1. PUMP INSTALLATION

Ideally and for convenience the pump should be positioned within reach of the side of the pond on a solid platform (e.g. paving slabs). The pump must be at least 200mm (8") below water level to avoid problems of freezing and low water levels in summer.

All electrical work should be completed by a qualified electrician.

Only use pump if completely immersed in water.

A. Waterfall/Filter Only

For use with a pond filter you will often get improved results with the pump sited at the opposite end of the pond to the filter return.

The pump comes as standard with pond-life friendly slots to help protect spawning life. In some ponds this may not be necessary and you may want to modify the pump to enable solids-handling as below. The pump may be connected to a waterfall or filter using 19mm (3/4"), 25mm (1") or 32mm (1 1/4") bore hose. For maximum flow use 32mm (1 1/4") hose connected directly to the hose adaptor on the rotor cover.

The rotor assembly can be rotated through 90° as required by twisting the front end of the pump.

B. Fountain (and Waterfall/Filter)

Insert fountain components as instructed in Fountain Kit.

2. MAINTENANCE / TROUBLESHOOTING

IMPORTANT SAFETY INSTRUCTIONS

- **Disconnect electrical supply from pump before removing from pond or contacting pond water.**
- **Do not carry or pull the pump by the cable.**

A. When flow from your pump is noticeably reduced or fountain display has deteriorated:

- Remove strainer cover by squeezing sides and pulling off.
- Clean cover and remove any weed or blockage around pump inlet rotor inlet.
- If you are using a fountain, remove and clean fountain head in water with a brush.
- Reassemble. If flow is still poor check to see if outlet pipe has become kinked or blocked.

B. If flow is stopped

- Disconnect power.
- Remove cover and check for free rotation/breakage of rotor.
- If rotor will not turn or is broken, remove and clean - replace if broken or worn.
If in doubt please contact Closer Pets Customer Service.
- Reassemble in reverse order after careful cleaning of all components.
- Replace the pump in water before reconnecting power to start pump. If pump does not start or stops again please contact Closer Pets Customer Service.

Model	Voltage	Power (W)	Flow Rate	Lift (M)
472	220-230V 50HZ	52	5000 L/H	4.0
473	220-230V 50HZ	70	6500 L/H	5.0
474	220-230V 50HZ	80	8500 L/H	5.5

SPARES

Pump Model	Spares Kit Code	Product
472	485	5000 Intermediate Pump Service Kit
473	486	7000 Intermediate Pump Service Kit
474	487	9000 Intermediate Pump Service Kit



GUARANTEE

We offer a 1-year standard warranty. However, if you register your product at www.closerpets.com/pages/product-registration within 14 days of your purchase you get an additional 2-years warranty and Pet Mate Ltd. will guarantee your product for a period of 3 years from the date of purchase. If you do not have access to a computer, please send details of your purchase with a copy of the receipt along with your name and address, and our Customer Services team will handle this for you. Please get in touch with Closer Pets Customer Services if you have a problem with your purchase. The guarantee is here to protect you if any defect arises due to faulty materials or manufacture. Any defective items will be repaired or replaced free of charge by Pet Mate Ltd, provided the defect has not been caused by neglect, misuse or normal wear and tear. Your statutory rights are not affected. To get started, register now by scanning the QR code or by following the link here: www.closerpets.com/pages/product-registration



IMPORTANT: Dispose of damaged/faulty/end-of-life products in accordance with locally applicable regulations for your country. **UK/EU:** Refer to Terms and Conditions section *EU Waste Electrical and Electronic Equipment (WEEE) Directive* on www.closerpets.com for more information.



Hereby, Pet Mate Ltd., declares that this product is in compliance with the essential requirements and other relevant provisions of EU and UK Directives. All Declarations of Conformity (DoC) may be viewed at www.closerpets.com/pages/eu-doc.